

EXPLORATION LICENCE APPLICATION 007264

- Unavailable for Searching or Exploration or Mining MRSDA 1990 Sec 6. Includes National, State & Wilderness Parks and Reference Areas
- Exempted from being subject to Exploration &/or Mining Licences. MRSDA 1990 Sec 7. May be revoked by notice in the Govt Gazette.
- Restricted Crown Land. Schedule 3 of MRSDA 1990. Consent required to do work on the land.
- Other Crown Land
- Commonwealth Land. Subject to Commonwealth legislation.
- Exploration Initiative Area exempted for a limited time from being subject to Exploration and/or Mining Licences. MRSDA 1990 Sec. 7
- Land not included in the Licence due to a licence or licence application existing or having priority at the date of application.

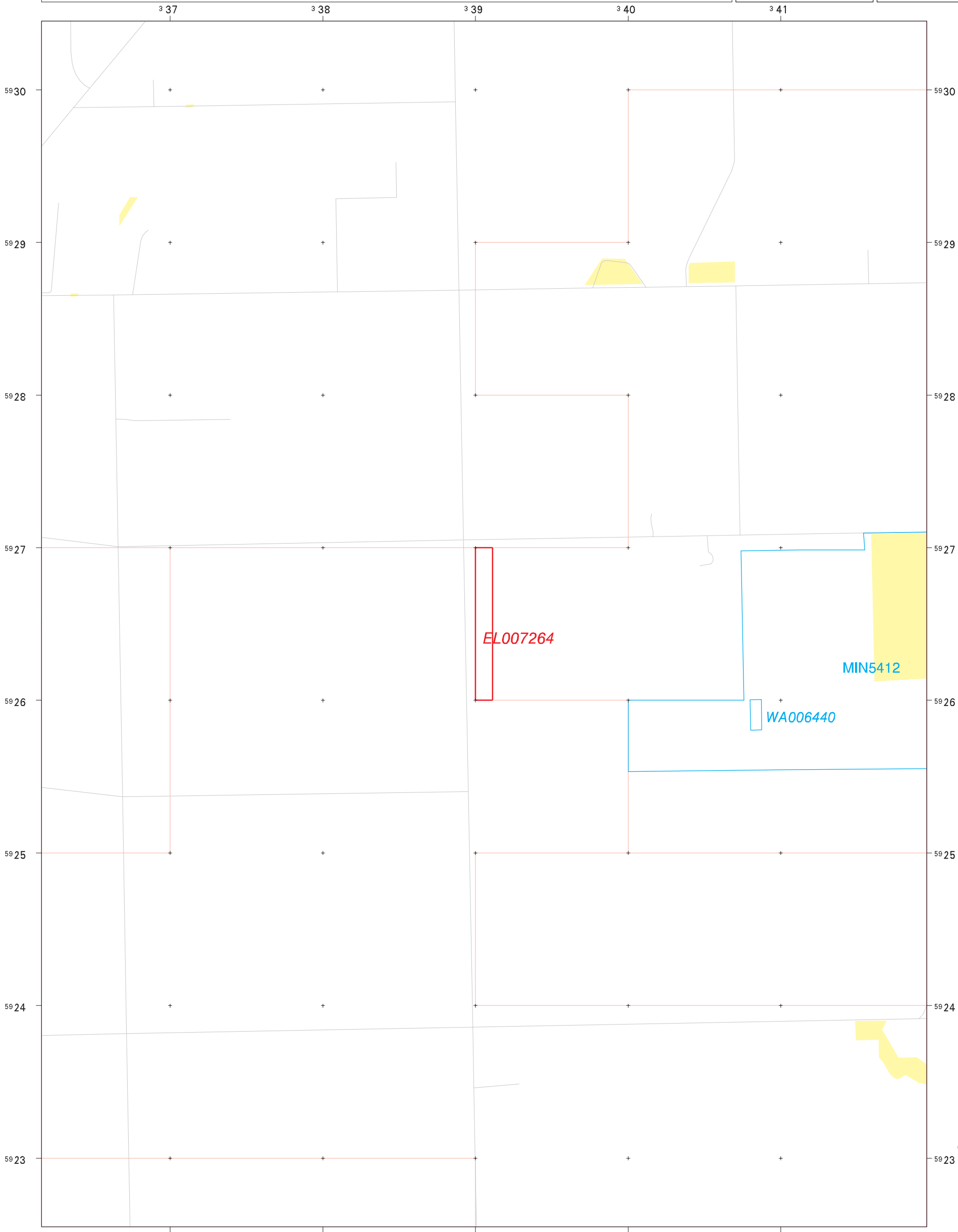
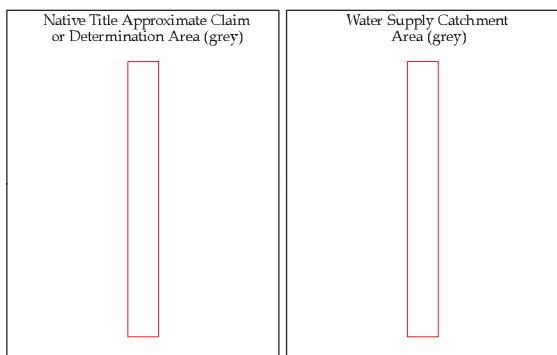

GDA94
MGA
ZONE 55

SCALE
1:25,000

1:100 000
Mapsheets

NAGAMBIE (7924)

Area in Grats

Total 1
NET 1



Produced by
Christy Thiagarajah
(03) 8392 7095
on
06/04/2020

NOTE: The accuracy of the location of the land status areas may vary according to the scale and mapping accuracy. Areas of private land within Crown Land may not be shown. The precise locations should be verified with Crown Land & Assets if access to the land is proposed.

Where the Licence Application abuts unavailable land, the Licence boundary is defined by the boundary of the Unavailable Land. Discrepancies on this plan between the boundaries may be due to scale and mapping inaccuracy.

All Private land, roads and road reserves has been excised from this Licence